

## 32 109 DC1 LINEARE ETTGREPSBATTERI TIL SERVANT, DN 15 XS-SIZE

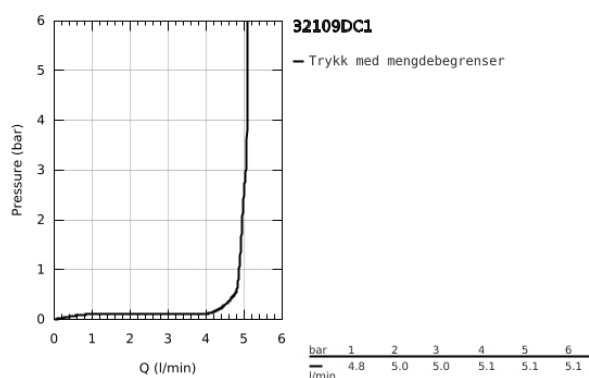

### PRODUKTBESKRIVELSE

- Colour: supersteel
- etthullsmontasje
- metallhendel
- GROHE SilkMove 28 mm keramisk patron
- med temperaturbegrenser
- GROHE Long-Life-overflate
- GROHE Water Saving-teknologi for mindre vannforbruk
- maximum flow rate (at 3 bar): 5 l/min
- SpeedClean mousseur
- GROHE FastFixation Plus installasjonssystem
- oppløft med avløpsgarnityr 1 1/4"
- fleksible tilkoblingslanger

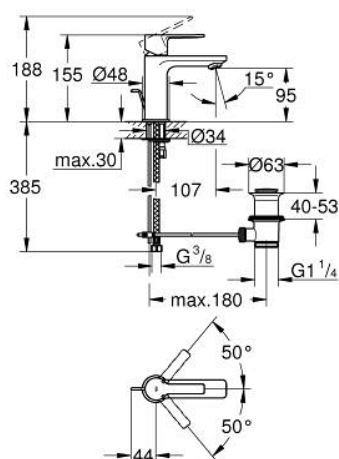

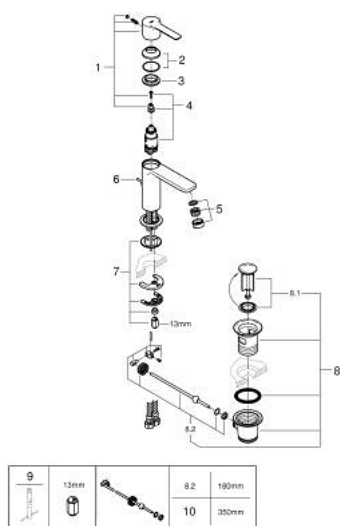

\* Optional accessories